

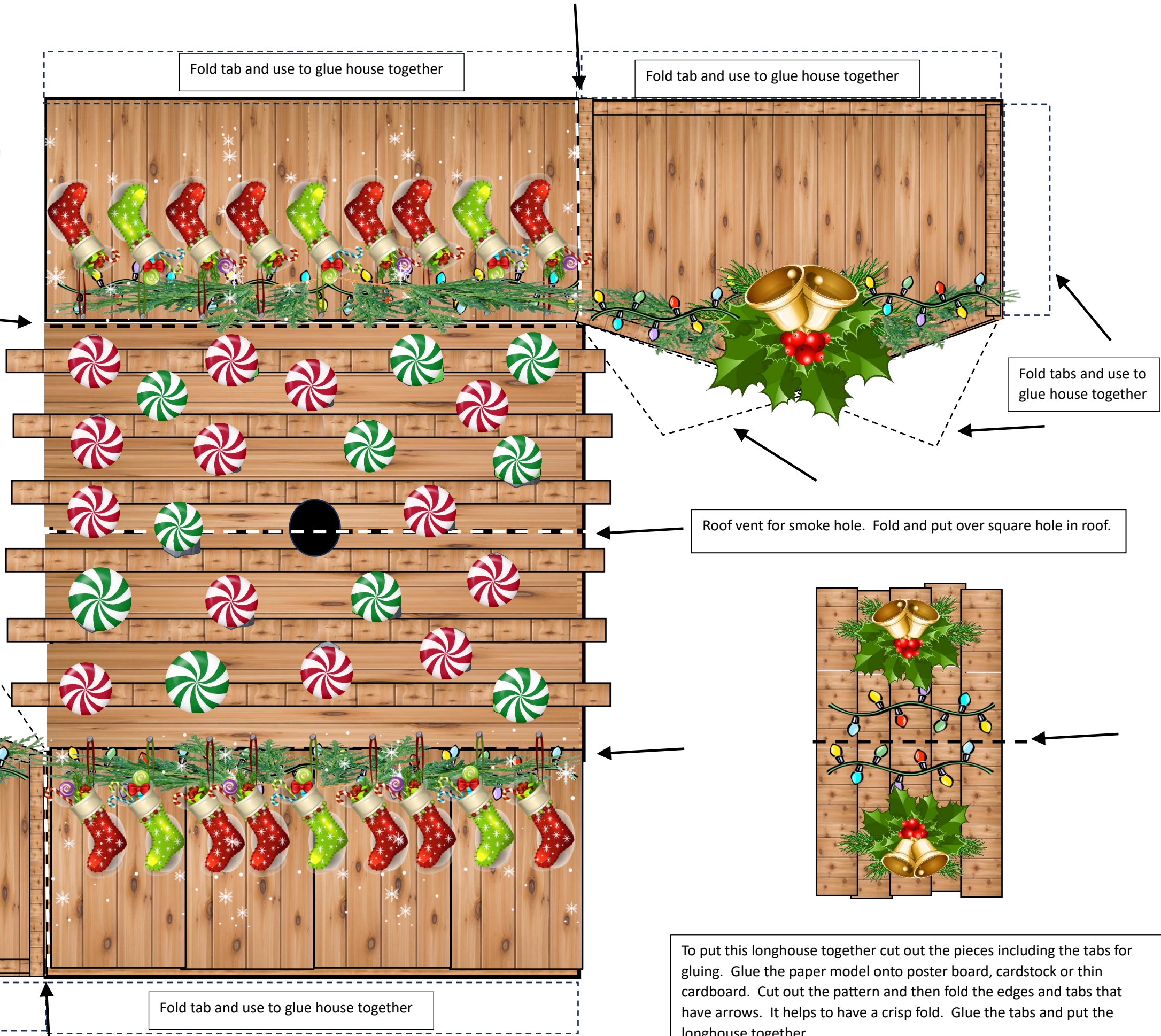

Photos of finished Christmas Longhouse

All black and white colouring figures are courtesy of Gitxsan artist, Michelle Stoney. For use for educational purposes only. It might be easier to print bigger versions to colour and then make them smaller with colour photocopies. Bigger versions can be found [here](#).



To put this longhouse together cut out the pieces including the tabs for gluing. Glue the paper model onto poster board, cardstock or thin cardboard. Cut out the pattern and then fold the edges and tabs that have arrows. It helps to have a crisp fold. Glue the tabs and put the longhouse together.